

# Program Funding



The Department of Housing & Urban Development (HUD) subsidizes many of the City of Berwyn Senior Programs. This grant provided by HUD is allocated by the Community Development Department.



## Apply for Services

Prior to using our mobility services, an application must be completed and returned to:

City of Berwyn  
Attention;  
Senior Services  
6700 West 26th Street  
Berwyn IL. 60402



MAYOR ROBERT J. LOVERO

## Contact Us



708-788-2660  
(ext 6489 or 6492)



6700 26th St., Berwyn



SeniorServices@berwyn-il.gov

[www.berwyn-il.gov](http://www.berwyn-il.gov)



**7-DAYS A WEEK  
CURBSIDE  
PICKUP  
AVAILABLE!**



**MOBILITY  
SERVICES**

## Transportation Program

Serving passengers 60+  
seniors and disabled  
residents

## Program Guidelines

Passengers must be Berwyn residents and at least 60 years of age or disabled.

If you are under 60 and disabled, you must submit proof of disability with application.

## Reservations

After application is submitted & approved, to make a reservation, please contact the Administrative Assistant Monday through Friday between 8:00am and 4:15pm at 708-484-2510.

Reservations must be made as far in advance as possible, due to the limited number of seats on vans. We ask for at least 7-10 days notice.

### No same-day reservations.

Reservations must be cancelled in a timely manner in order to accommodate those residents on transportation waiting list.

## Program Hours

### Monday through Saturday

8:00am-4:30pm

- First pick up at 8:15am
- Last pick up at 4pm (within City of Berwyn area borderline).

### Sunday

8:00am-1:00pm

- First pick up at 8:15am
- Last pick up at 12:30pm

**EXPANDED DAYS!**

## Cost

The fee is \$1.00 per person each way.



**SAME AFFORDABLE COST!**

Drivers DO NOT carry change, please be sure to have the correct amount of cash at time of pick-up.

## Boundaries

**EXPANDED BOUNDARIES!**

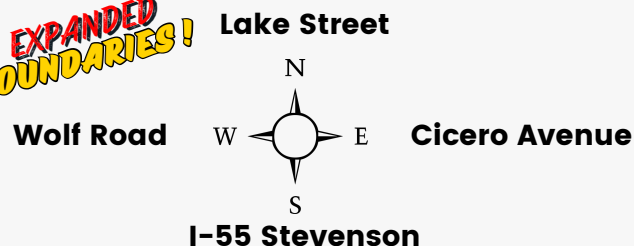

## Grocery Store Transport



Grocery transport is available during program hours.

Shopping appointments must be scheduled in advance.

Shoppers are limited to three (3) grocery bags per person.

Assistance is provided for transport ONLY. Drivers cannot assist with grocery shopping.